

RIPPLE MAKER II & RIPPLE MAKER II PRO GUIDE



PRINTING ON DRINKS

Choose your own creation or from a list of pre-defined designs

Pre-defined designs

Ensure the glass is placed in the center of the tray within the white circle. Remember to have the glass logo, if any, facing the left-hand side.

Simply select the channel of choice from the drop-down menu or scroll down to the desired channel e.g. Guinness

Choose your desired design and press to print

Enjoy!

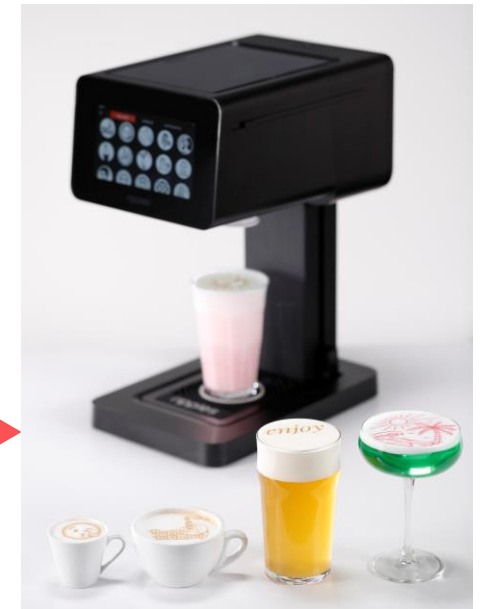
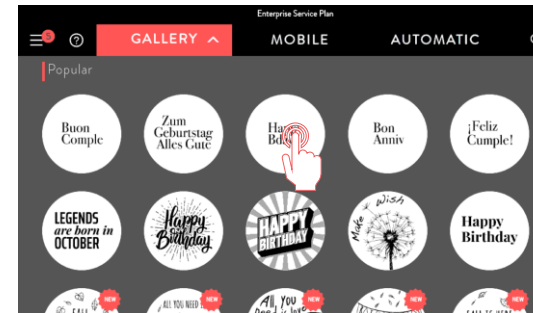
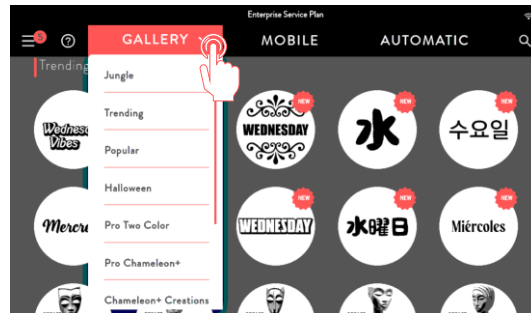

CUSTOMISE YOUR DRINK

[Watch the YouTube Tutorial Click Here.](#)



Customize your own drink through the **Web App with a photo**

Custom designs

Scan the QR code associated with the Ripple Maker and go to the Web App

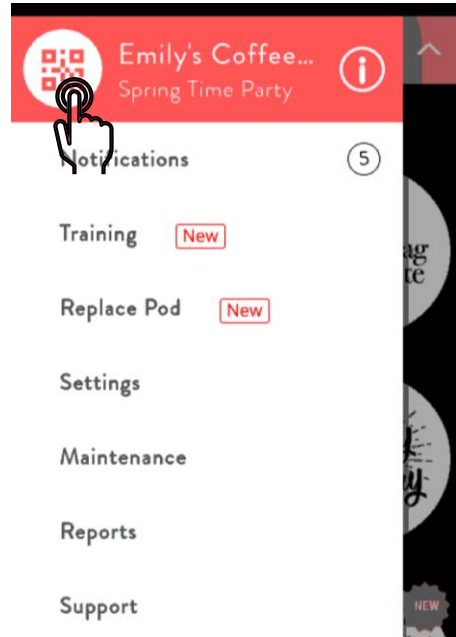

Select the "Photo" icon

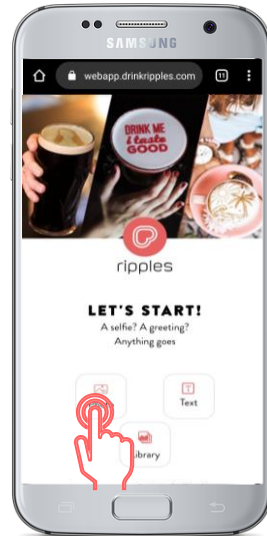

Once you upload your photo you can move it around to fit within the frame

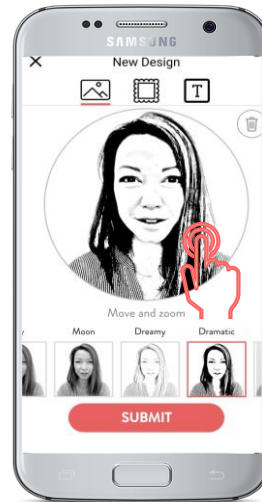

You can also pinch the image to make it larger or smaller to best fit the frame

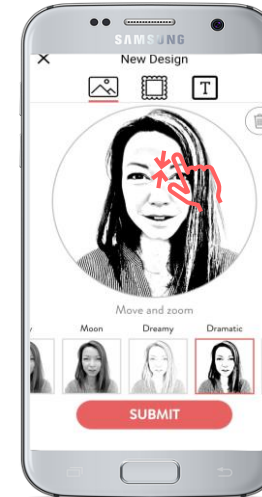

Next step is to choose the best filter, creating the best contrasting image.

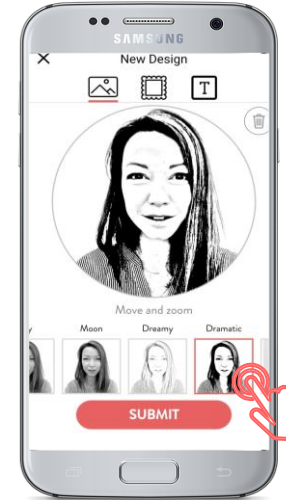

Once complete select "Let's print", this generates a queue number. Select your queue number and print from the "Mobile" tab on the Ripple Maker.

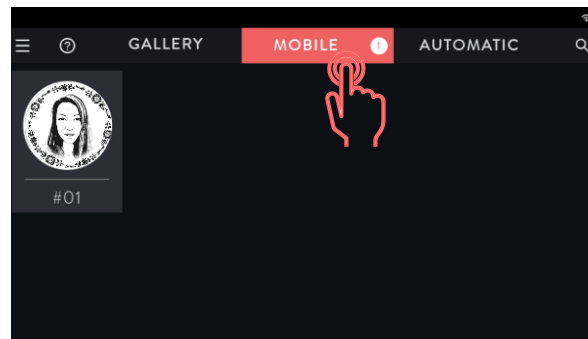

Click on your design to print

Click "Print another" to create another design.

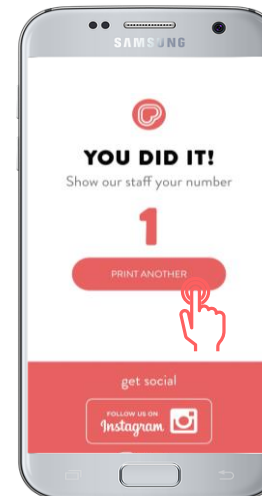

Lastly you can select the frame tab to select the desired your frame

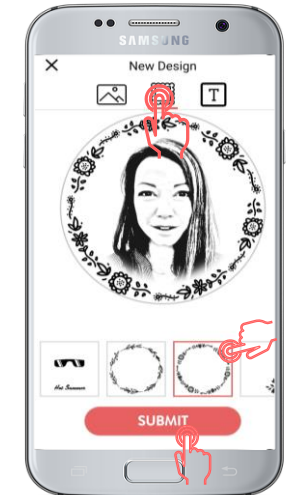

CUSTOMISE YOUR MACARON – 1/2

Customize your own Macaron through the Web App

Custom designs

Scan the QR code associated with the Ripple Maker II and go to the WebApp

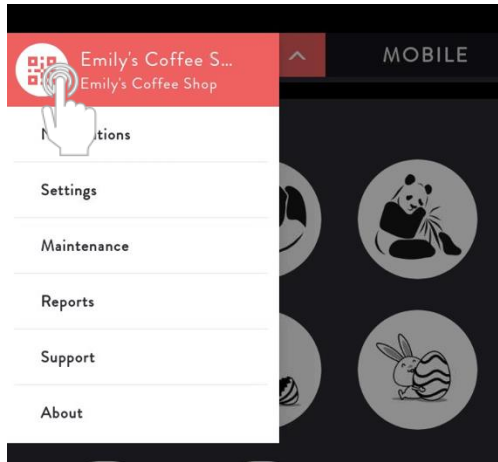

ABOUT

Location: Emily's Coffee Shop



Select the Macaron icon

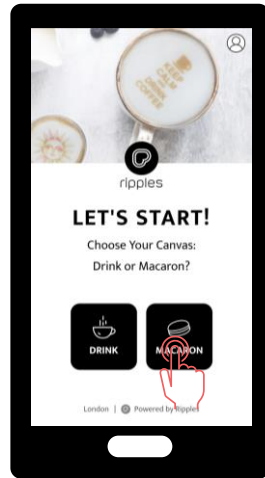

Choose how many Macarons you want to customize

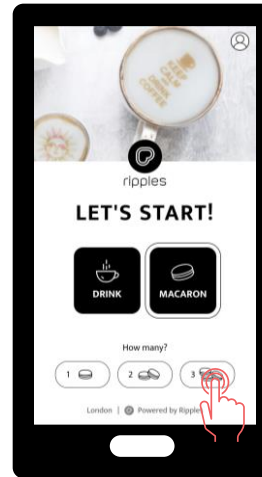

Select which Macaron to customize. Note the position on the screen will match up to the placement of macaron on the platform

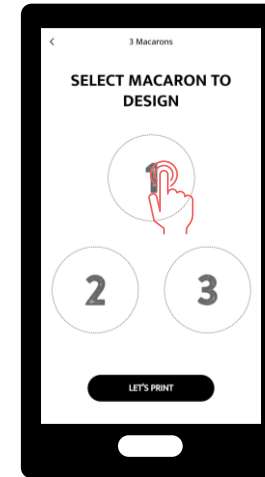

Select "Create my own" or you can choose from an existing design

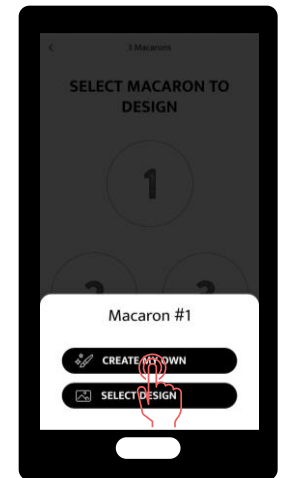

[To Watch the YouTube Tutorial Click Here](#)
[Full Macaron Tutorial Article Click Here](#)

CUSTOMISE YOUR MACARON – 2/2

Customize your own Macaron through the Web App

A help screen will appear if you are unsure, click “Got it” to continue

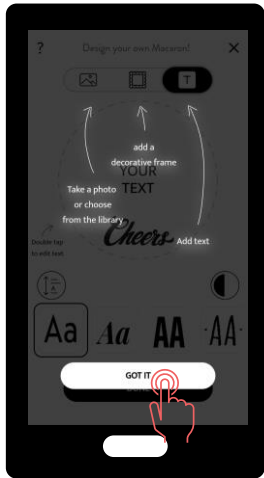

Select the text tile and double click “Your text” to write

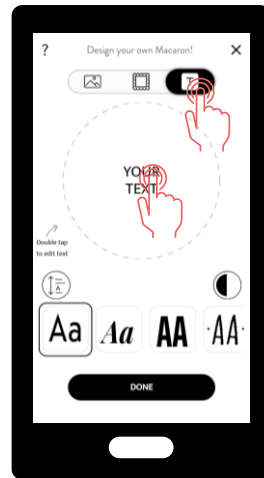

Change your font, pinch in and out to adjust size, then click “Done”



Repeat the process for the rest of the Macarons



Review all 3 of your Macarons

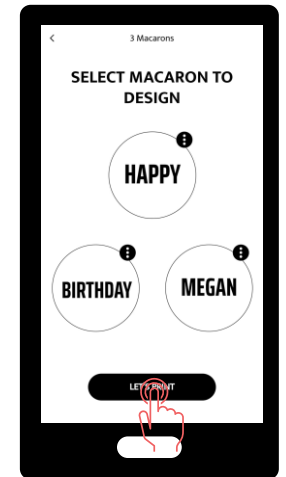

Once complete select “Let’s print”, this generates a queue number. Select your queue number and print.

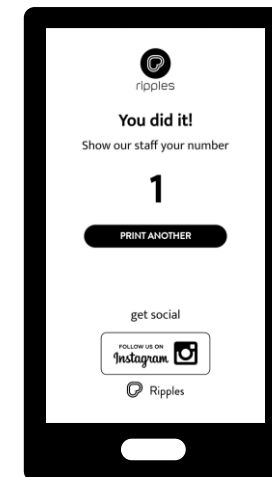

[To Watch the YouTube Tutorial Click Here](#)

CUSTOMISE YOUR DRINK

[Watch the YouTube Tutorial Click Here.](#)



Customize your own drink through the Web App with text

Custom designs

Scan the QR code associated with the RM and go to the WebApp

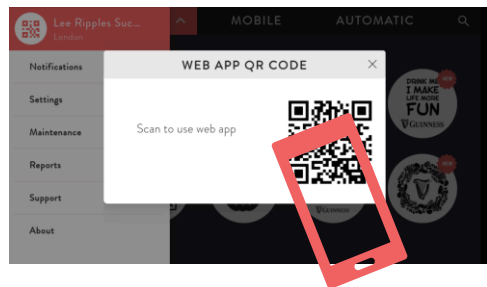
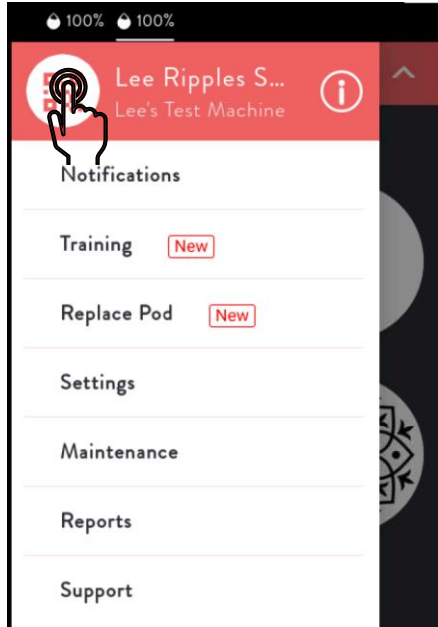

Select the "Text" icon

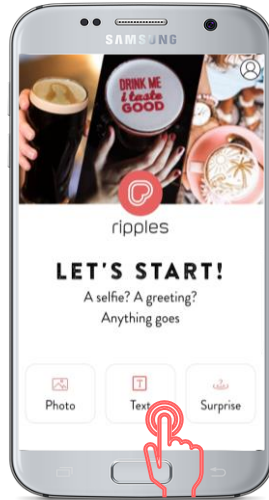

Double tap the "Your Text" to edit the text



Keypad should pop up, enter your desired text and click "I'm done" when ready



You can also pinch the image to make it larger or smaller to best fit the frame



Click on your design to print

Click "Print another" to create another design.

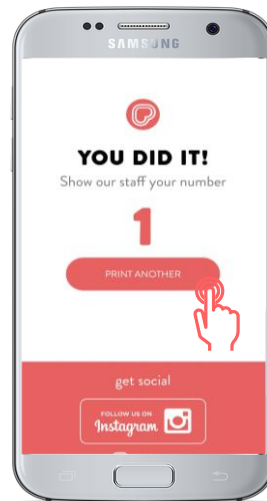

Select your queue number and print from the "Mobile" tab on the Ripple Maker.

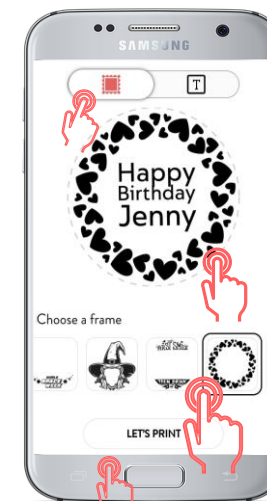

Finally select your desired frame, position correctly and select "Let's Print"



Here you can change the text alignment as well as the desired font

SETTINGS FOR DRINKS – OPTION 1

Follow the below settings for the best ripples on drinks

Click on the “Settings” tab in the menu list

Select the “Printing” tab

Unclick the “Auto” button under “Print Quality” and set print quality to “Enhanced”

Set your preferred cup size here as your default size. You can go in between sizes by clicking the pencil and then selecting a measure on the ruler.

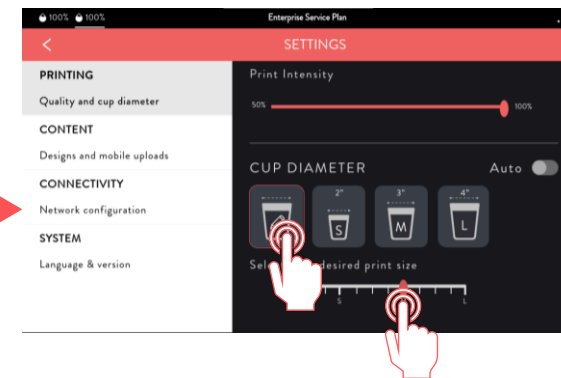
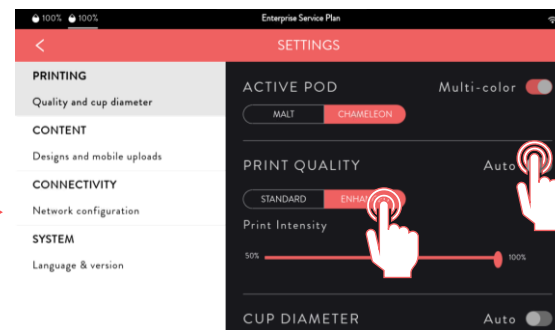
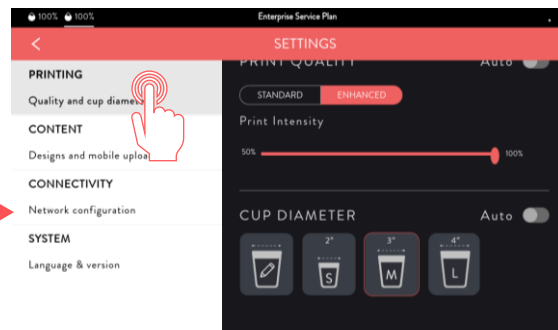
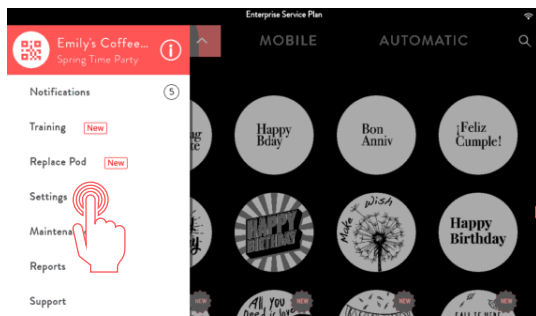

[To Watch the YouTube Tutorial Click Here](#)

SETTINGS FOR DRINKS – OPTION 2

If you wish to change the size of a single print, follow the below instructions

Long tap/hold on the design you wish to print

Select the preferred size you want to print and or the POD type you wish to use

Select “Print”. Note that only this print will change the size. The next print will set back to the default print size as setup in Settings

Select “Cancel” if you wish to cancel the print or close the screen when you are finished

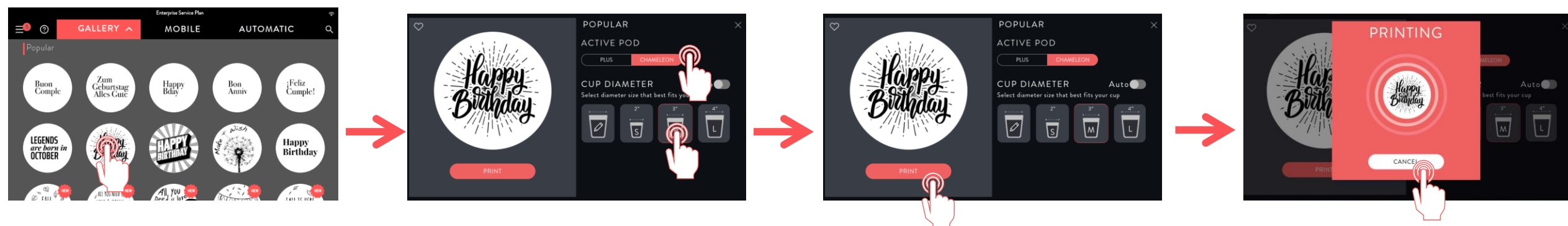

[To Watch the YouTube Tutorial Click Here](#)

SETTING YOUR POD TYPE

Here you can set your default Pod type for Ripple Maker II Pro versions

Ripple Maker II Pro Only

Click on the “Settings” tab in the menu list

Select the “Printing” tab

Make sure the “Multi-color” function is toggled as on.

Here you can now select your default pod type.

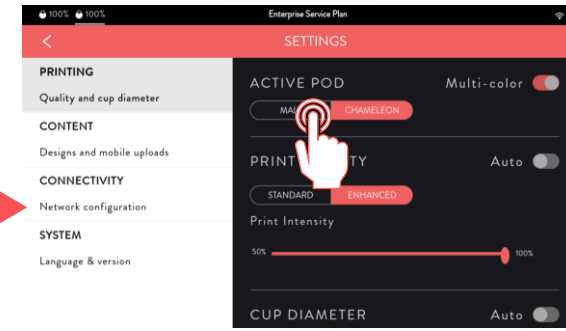
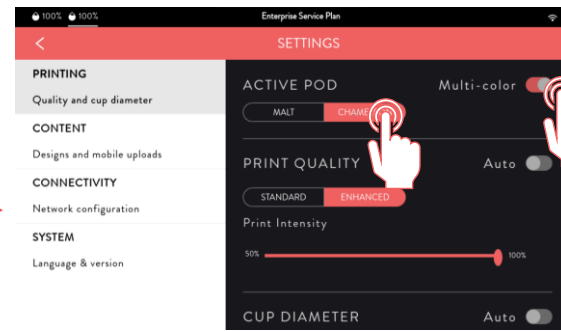
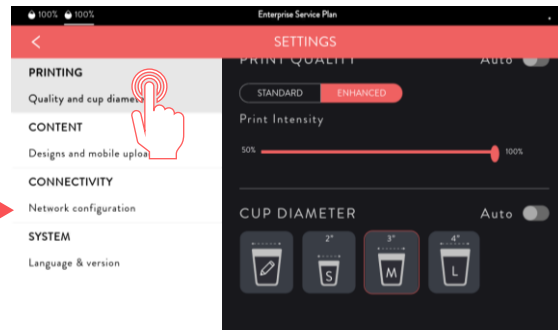
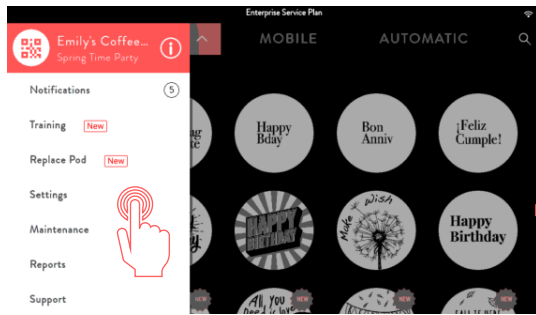

[To Watch the YouTube Tutorial Click Here](#)



DAILY MAINTENANCE

We recommend doing this daily as it helps with optimizing print quality

Click on the 3 lines to access the “Menu”

Select the “Maintenance” tab

Click on “Daily Maintenance”

Follow the onboard messages and ensure the drip tray is rinsed and placed back. Once complete click “Next”

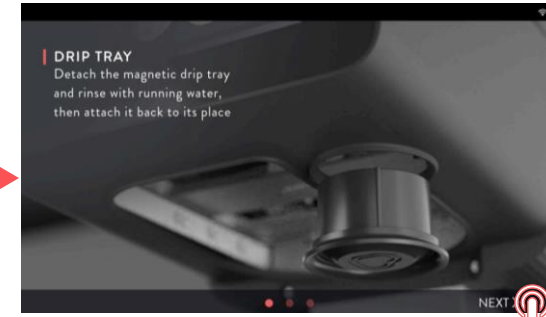
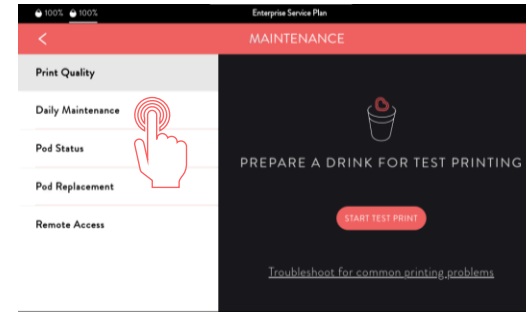
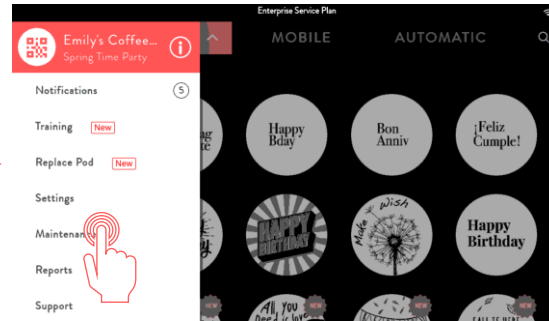
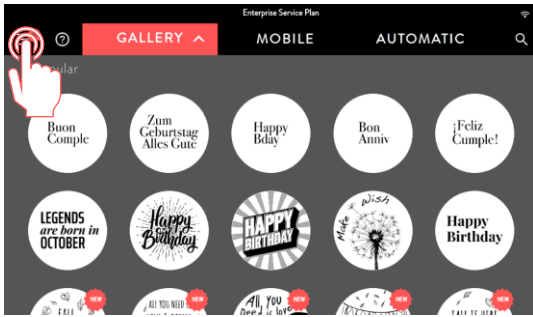

Click “Next” once complete

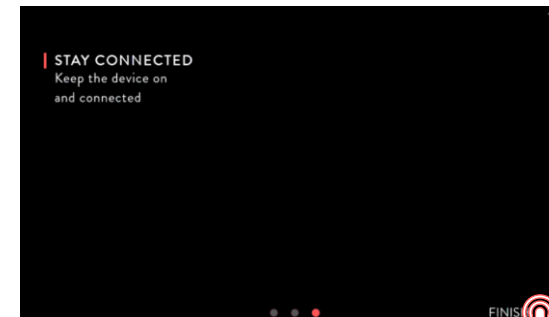
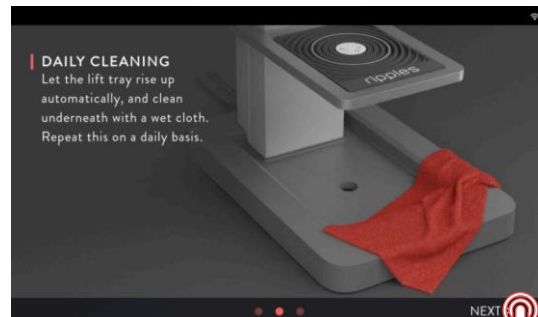

Click “Finish” once complete



[Watch the YouTube Tutorial Click Here](#)

REPLACING THE POD



[RIPPLE MAKER II – Watch the YouTube Tutorial Click Here](#)

[RIPPLE MAKER II PRO– Watch the YouTube Tutorial Click Here](#)

Follow the steps below to correctly change the POD

Open the menu and select the “REPLACE POD” tab

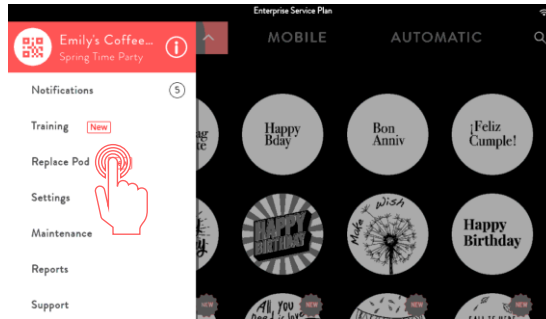

Select the “POD Replacement” tab under “Maintenance”

OR

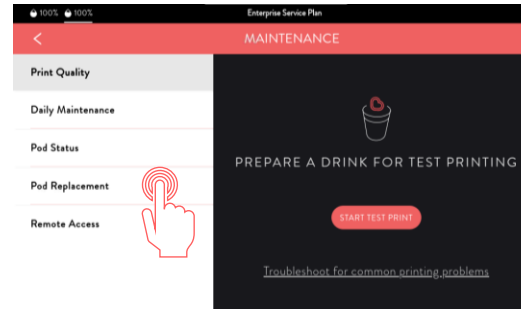

Follow the onboard prompts and click “Next”

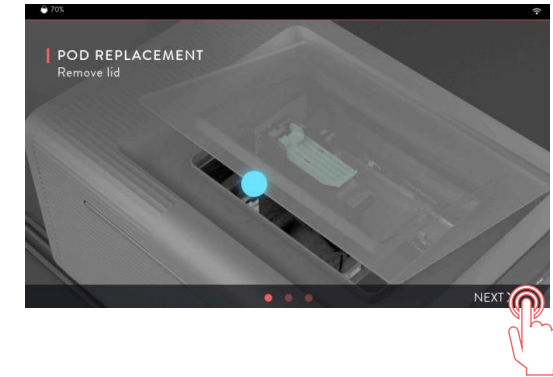

Important to take care when handling the POD as they are fragile. Keep an eye out for any damage to the POD.



Remember to handle the POD with care and only use 2 fingers of pressure

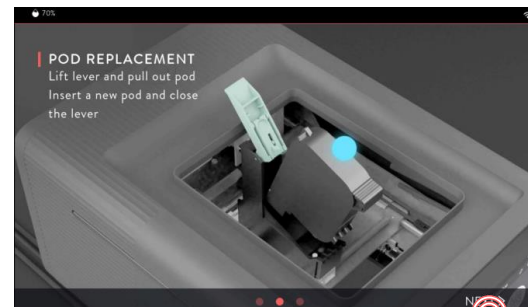

Follow the onboard prompts and click “Finish”

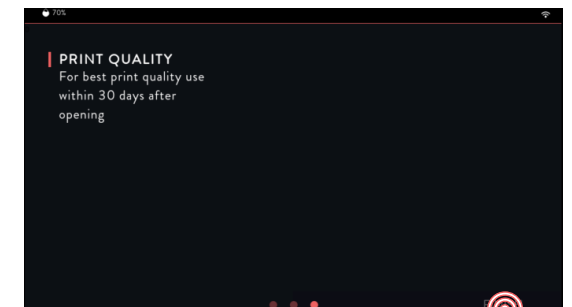

UPDATING CONTENT

This shows how to update and/or sync content

Click on the “Settings”
tab in the menu list

Select the “Content” tab

Click the “Sync”
button to sync
the latest
content

Allow a few seconds to
update. You should
now have an updated
sync time.

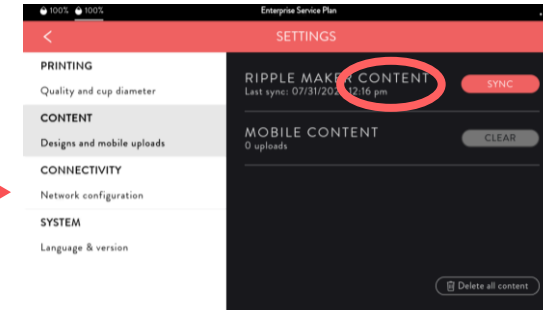
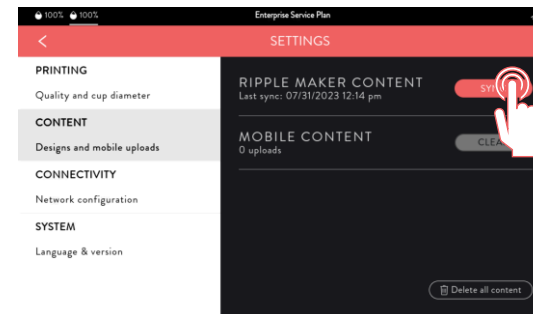
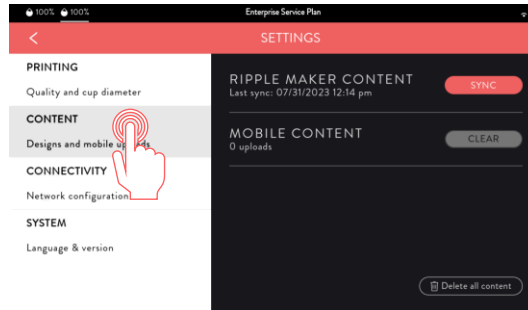
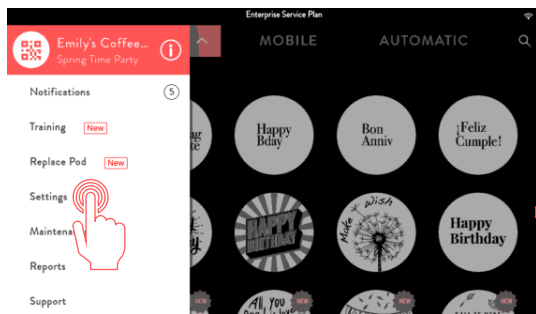

[To Watch the YouTube Tutorial Click Here](#)

CONNECTIVITY SETTINGS

Follow the below settings to connect to a network

Click on the “Settings” tab in the menu list

Select the “Connectivity” tab and click the “Change” button

Scroll to find the desired network and click “Connect”

Type in the password, then click “Connect”

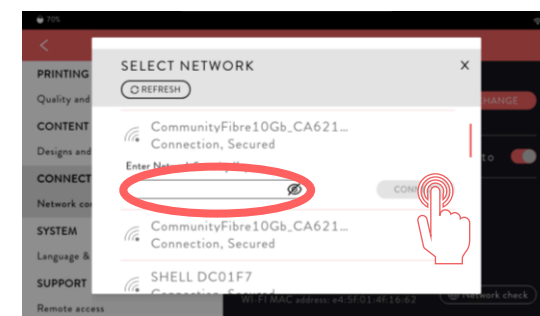
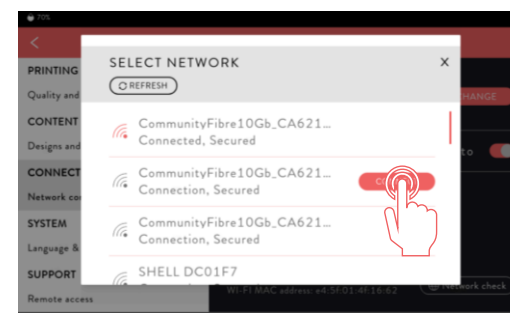
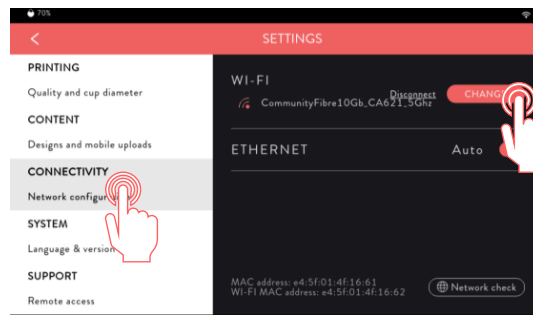
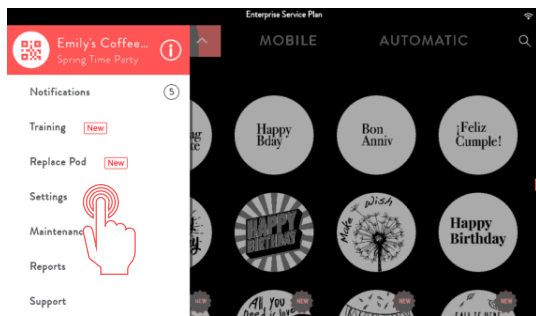

[To Watch the YouTube Tutorial Click Here](#)

CONNECTIVITY SETTINGS

Connecting to a **hidden network**, follow the below steps

Click on the “Settings” tab in the menu list

Select the “Connectivity” tab and click the “Change” button

Scroll to the bottom and click “Add Network”

Type in the network name and password, then click “Connect”

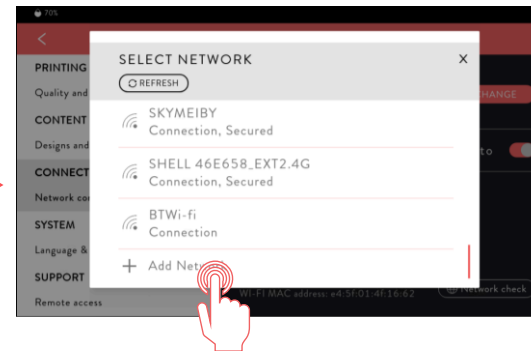
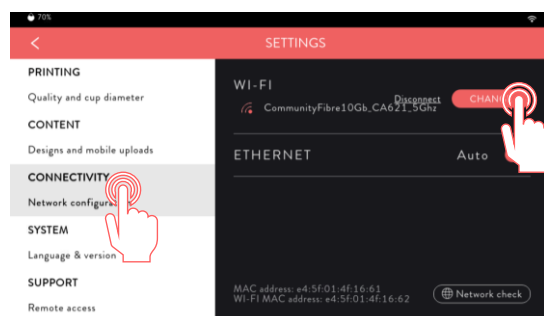
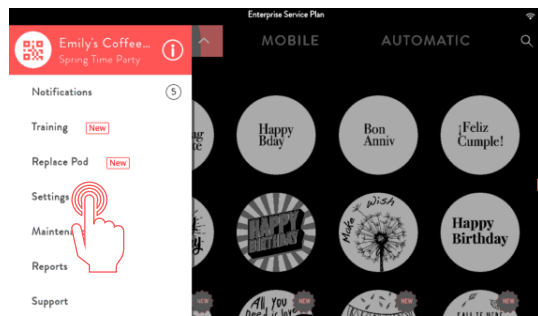

[To Watch the YouTube Tutorial Click Here](#)

PRINT QUALITY

How to improve your print quality

Click on the “Maintenance” tab in the menu list

Select the “Print Quality” tab and click the “Start Test Print” button (make sure you have a cup with paper to run a test print)

Scroll through the onscreen examples to find your issue, click the suggestion and follow the onboard messages

Run another test print to see if the issue has been resolved.

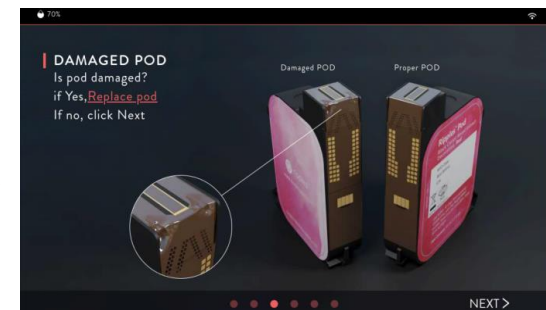
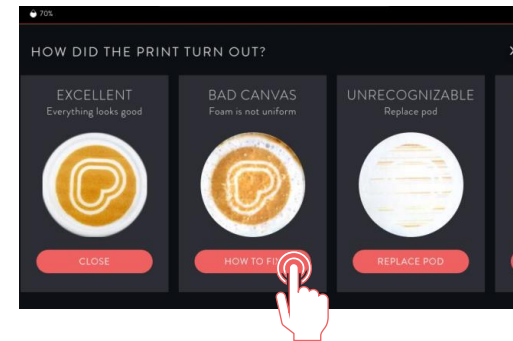
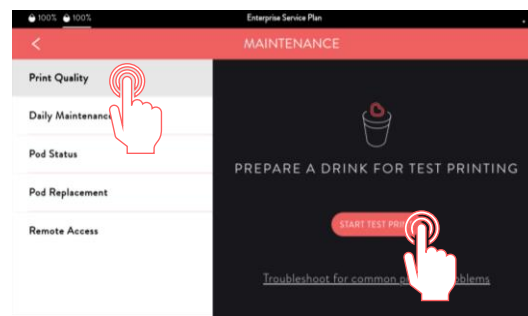
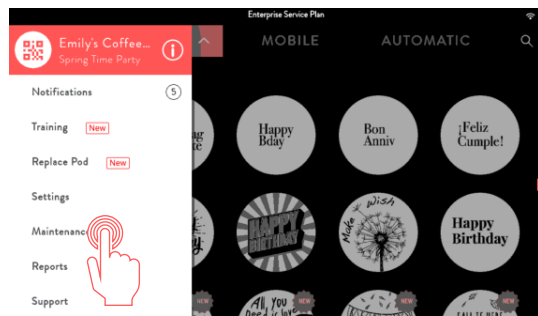

[To Watch the YouTube Tutorial Click Here](#)

REPORTS

How to manually check your print numbers on the Ripple Maker II

Click on the “Reports” tab in the menu list

Here you can manually view your print numbers by day in the “Week” view

Toggle to “Month” to view the weeks in the month

Click the previous arrow to view the previous months prints

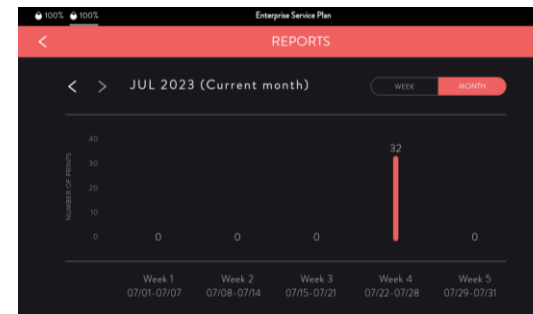
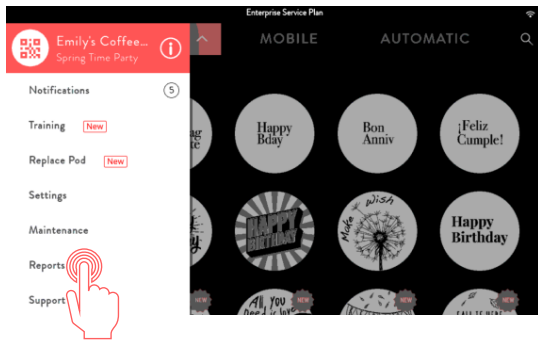

[To Watch the YouTube Tutorial Click Here](#)

TRAINING

Training on all things Ripple Maker right from your Ripple Maker screen.

Click on the new “Training” tab in the menu list

Select your desired training section

Click through the options to the one that fulfils your need

Scan the QR code and follow the link, this will now direct you to our Help Centre with articles and instructional videos

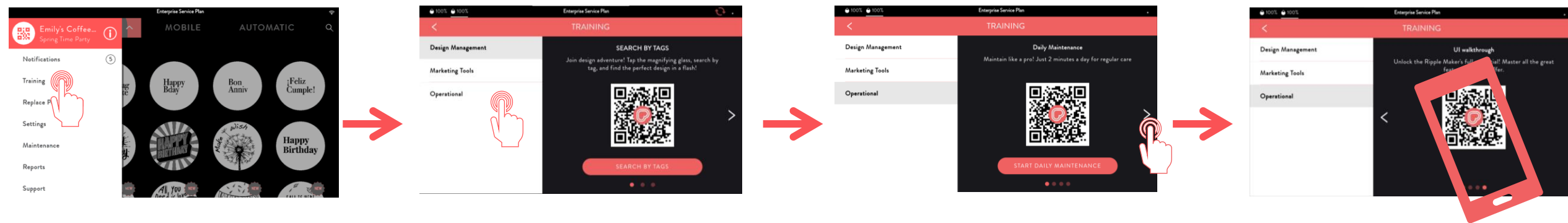

[To Watch the YouTube Tutorial Click Here](#)

CONTACT SUPPORT

If you need any extra assistance, please contact support

Simply click on the “About” button to access support contact details

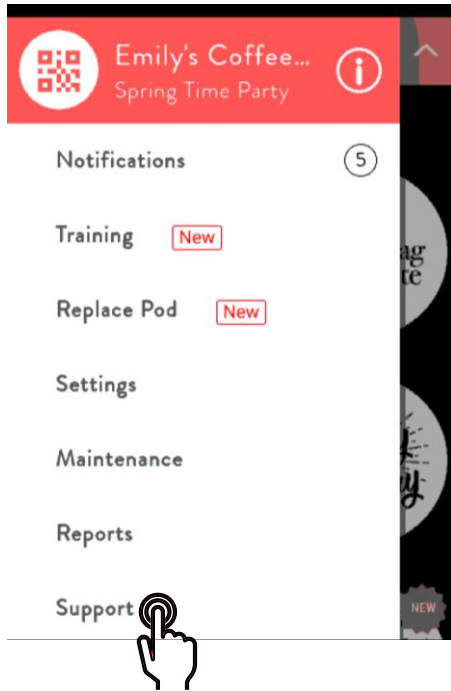

Either scan the QR code to open a WhatsApp conversation, click on the “Open a service call” button or email to contact support



support@drinkripples.com
[Click here for Full Contact Details](#)

THANK YOU